



How to use

How to operate Emax EVolution

Foot pedal

Control unit

Motor handpiece



Ultra-precision brushless
micro-grinder

Emax Emax EVolution
EVolution

① Names of parts

Forward/reverse select switch

The direction of motor rotation can be selected.



▶ Forward rotation (clockwise)



▶ Reverse rotation (counterclockwise)



Motor rotation speed display

40 = 40,000 rotations/min

Speed control volume

The rotation speed can be easily adjusted.

LOAD meter

Displays the load status of the motor.

Motor connector A

Power supply switch

Motor connector B

Motor switch /

When  /  is turned ON/OFF, the motor connected to motor connector A/B will rotate/stop. *  and  cannot be operated simultaneously.

② How to change tools

1. Loosen the ring and remove the tool.
2. Replace the tool and tighten the ring until a click sound is produced.



③ How to start the control unit

1. Turn speed control volume completely to the left.
2. Switch ON the power supply.



* Please make sure that the speed control display is set to .

④ How to start/stop the motor and adjust the rotation speed

* When motor connector A is connected to the motor.

— To start —

1. Press  or the motor smart switch. The motor starts to rotate.



Motor smart switch

— To stop —

2. When the motor is rotating, press  or the motor smart switch. The motor stops rotating.

— To adjust the rotation speed —

1. Turn the speed control volume to adjust the rotation speed.



5 Convenient functions

—FIXPEED function—

FIXPEED allows everyone to set the speed of the motor in advance. The speed that is frequently used can be easily set at the touch of a button.

How to set

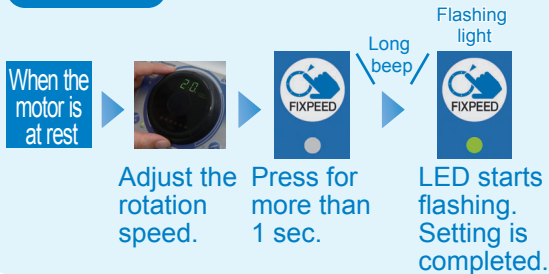

How to cancel a setting

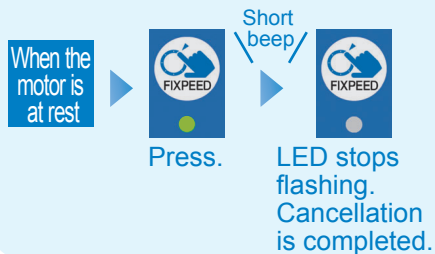

NAKANISHI INC. 

www.nakanishi-inc.com

700 Shimohinata, Kanuma, Tochigi 322-8666, Japan

Contents are subject to change without notice.

NSK America Corp

www.nskamericacorp.com

1800 Global Parkway, Hoffman Estates, IL 60192, USA

ver.190404

Excellent operability that makes the best use of advanced high performance

- ① 1. Loosen the ring and remove the tool.
2. Replace the tool and tighten the ring until a click sound is produced.



- ② Insert the motor cord plug and the power supply cord.



- ③ 1. Turn speed control volume completely to the left.
2. Switch ON the power supply.



* Please make sure that the speed control display is set to **■**.

- ④ Press the motor ON/OFF switch or the smart switch.
The motor starts to rotate.



- ⑤ Adjust the rotation speed using the speed control volume.



* The motor stops when the motor ON/OFF switch or the smart switch is pressed again.

Names of parts



Motor switch

When **①**/**②** is turned ON/OFF, the motor connected to motor connector A/B will rotate/stop. * **①** and **②** cannot be operated simultaneously.

Specifications (Ring Standard Emax EVOLution Standard Set)

Control unit

- Model NE249
- Weight 2.3 kg
- Power source AC120V, 50/60Hz, 41VA / AC230V, 50/60Hz, 41VA
- Dimensions W130 × D254 × H97 (mm)

Handpiece

- Model ENK-410S
- Motor Attachment IR-310
- Max power 73 W
- Max torque 4.3 cN·m
- Weight 182 g (w/o Cord)
- Speed range 1,000 - 40,000 min⁻¹